



World's Leading Steel Fabrication Management Solution

Streamlining and simplifying all of your steel fabrication processes.



THE FUTURE OF STEEL FABRICATION

Used worldwide to reduce costs while maximizing profitability

STRUMIS will connect your business resources reducing time, cost and wastage for greater efficiencies, traceability and productivity

Give your company the competitive edge

Bringing Structure to Steel in the 21st Century

Steel fabrication in the 21st Century calls for the utilization of technology to remain profitable in an ever more dynamic and competitive industry. Leveraging technology in steel fabrication processes is no longer an option, it is a requirement for fabricators that want to remain competitive. STRUMIS serves both the largest and smallest fabricators, and enables fabricators to better manage their business resources, improve efficiencies, increase productivity, and ultimately leads to greater profitability.

STRUMIS' integrations with partner systems enables fabricators and detailers to make quick, informed decisions to minimize cost and disruptions, by providing real-time status for materials and fabrication status.

Industry Leader

Adopting STRUMIS is acknowledged as a commitment to business excellence; this will attract new customers while also improving existing customer satisfaction.

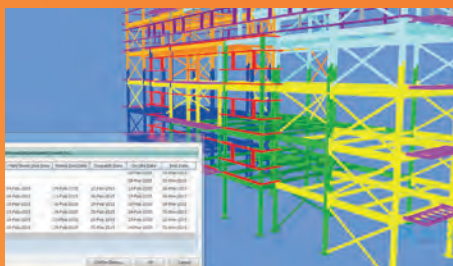
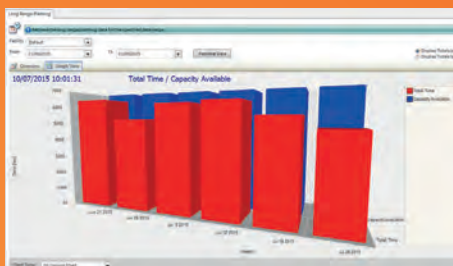
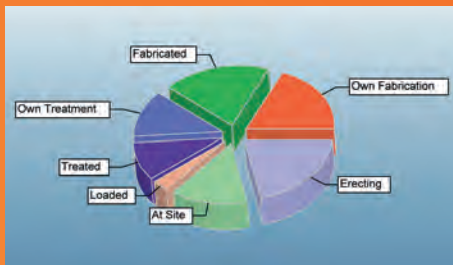

Benefits:

- Increase Productivity
- Save Time, Reduce Costs
- Real Time Traceability
- Streamline Workflow
- Maximize Material Efficiencies
- BIM Collaborative Communication
- Regulatory Compliance

Advanced Integration



KALTENBACH



STRUMIS enables companies to increase efficiency and improve profitability

Features and Modules

BIMReview

STRUMIS' integrated BIMReview tool provides 3D project visualisation, communication and real-time status updates to all project parties – from estimating to erection. Features include:

- Clash checking
- Mark-up
- Model sharing
- Movie making

Document Management

Manage and control all your project documents in a single location and log and track all RFIs, transmittals, fabrication drawings, approval status, NC files, GA's, method statements and material test certificates for transparency across your project.

Purchasing

Streamline procurement and reduce waste using STRUMIS' advanced nesting capabilities.

- Electronic Data Interchange (EDI) provides a seamless link to steel suppliers to speed-up the procurement of your steel requirements
- Inventory Pick Lists and Cutting Instructions for workshop machinery

Invoice/Billing

Prepare and manage all project invoices using STRUMIS Progress Billing.

- Links with 3rd party accounting and ERP/MRP programs
- Eliminate duplicate entry and provide real-time project cost analysis

Executive Dashboards

STRUMIS contains customizable dashboards providing managers with critical project and business performance data.

- Dashboards are simple to configure and use
- Provides an effective solution for delivering project statuses, costs, & time analysis graphs to enable informed decisions.

Project Budget Control

- Track costs on every project with STRUMIS Budgets with real-time monitoring of orders, inventory transactions and employee timesheets.
- Quickly access and manage change order and revisions to contracts
- Control and monitor project costs in real-time.

Production Planning

STRUMIS provides integrated Long Range and Detailed Planning tools for complete accuracy and traceability when planning your workforce and machinery resources.

Estimating

Increase estimating capacity and accuracy:

- Importing 3D BIM models or 2D electronic take-offs
- Apply automated labor and connection details
- Analyse historic win and value patterns to target the right projects
- Achieve consistent pricing across your estimating team

CAD Integration

STRUMIS provides bi-directional integration with leading CAD systems including:

- SDS/2
- SolidWorks
- Inventor
- Tekla
- Advance Steel

Critical data including purchasing, inventory, fabrication, invoicing, shipping, and erection status is communicated back into the 3D model for project transparency.

Inventory & Material Traceability

Manage your materials across multiple locations using STRUMIS Multi-Facility functionality. From the moment material is ordered, to site delivery, to erection, STRUMIS tracks every part and assembly.

- Record cast/heat numbers
- Store material test certificates for complete material traceability helping quality control procedures accreditation
- Advanced linear nesting, WT nesting, & true shape plate remnants ensure your stock is 100% accurate and ensures maximum use of material

Production Control & Bar Coding

Manage your work force and machine resources and avoid bottlenecks in production.

- Automatically route parts and assemblies through the fabrication process
- Barcoding, iPhone/Android Mobile App, or console applications provide live statuses, traceability, and employee & process time stamps. View shop or field status updates from anywhere you may be
- Produce bills of lading and report on delivery status all the way to completion on site

STRUMIS pays for itself via the savings generated. Find out exactly what efficiencies can be made for your organization using **STRUMIS**.

This Is What Our Clients Say

STRUMIS was a proven solution on the technology platform that we trusted And it was the multi-location feature and this proven track record that were the main selling points. As a result of implementation we have successfully migrated away from our legacy software, to a solution that provides us much more visibility to our production status. STRUMIS has helped us focus on making sure our processes are built around supporting our shop. It also gives us the ability to manage our projects to the details our customers require.

- Drake Williams Steel

STRUMIS Estimating has allowed Metal Arts to unify and standardize our estimating department. With STRUMIS, we're able to create standard costs for everything from fabrication to part production, ensuring our estimators are all using the same data to create bids. Standardization has also decreased the time it takes to create bids, allowing Metal Arts the opportunity to increase our bidding, and dedicate time to further enhancing our estimating process. We're excited to continue to explore the capabilities of STRUMIS as we begin to integrate STRUMIS Production Console data with our Estimating process to enhance the accuracy of our bids.

- Metal Arts

King C Ironworks has been using Strumis for over 5 years, we like the ease of use and information that the software gives us. The material logs and production files are always in the server and can be easily reported. Exporting of material lists and reports is another great feature we like because we can customize each phase of the project. The Strumis BIMReview 3D Model Viewer for the 3D model and dxf files helps us look at each piece and decide if that is the floor we want to send into procurement. The reports for purchase orders and mults (material nesting/optimisation) is great and we can send all these nests straight to the suppliers from the STRUMIS program. Once the materials are received in our facility, the STRUMIS program gives us cutting sheets and inventory feed-sheets for the workshop machine operators providing 100% traceability. As VP of Operations, I am really happy with the program and it gives me all the information for each job in a nice breakdown.

- King C Ironworks, Inc

Following a comprehensive 6 month evaluation of the various steel fabrication management solutions available, we decided STRUMIS was the best solution for Canam Group due to a number of key factors. STRUMIS was by far the most comprehensive and feature rich solution available, enabling us to replace multiple legacy systems. Utilizing the STRUMIS Integration Platform and the latest .NET and SQL technology ensured we can integrate STRUMIS with our existing Oracle ERP system, our engineering and detailing software, as well as bar coding, tablet and CNC equipment. STRUMIS will save valuable time handling and managing key operational data across our multiple fabrications facilities.

- Canam

Your Free Consultation

Simply contact or visit us at www.strumis.com to arrange a free consultation, to see how you can start saving time and money, today!



Tel: (610) 280 9840
E-mail: sales@strumis.com
Website: www.strumis.com



STRUMIS LLC

2550 Eisenhower Avenue, 206B, Trooper, PA 19403, U.S.A

All information relates to the current software edition. As part of our commitment to continual product development, product and information is subject to change without prior notice. STRUMIS LLC cannot be held responsible for any inadvertent errors. All product names/logos mentioned are the trademark of their respective holders. © Copyright 2018 STRUMIS LLC. All rights reserved.